

516

C Style

Primary Applications:

- Insulation Blankets
- Animal Pots & Cages
- Bungee Cords
- Small Bag Closure
- Cargo Netting
- Bird Control Netting
- Rope
- Oil Absorption Socks

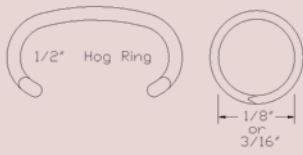

Description	Part #	Strip Size	Box Count	Box Weight	Box Per Skid	Skid Weight
Pneumatic Tool (tight closure)	HC516T	-	-	3 lbs.	-	-
Pneumatic Tool	HC516	-	-	3 lbs.	-	-
Galvanized Sharp Point	516G100	100 rings	10,000 rings	9 lbs.	100 boxes	900 lbs.
Galvanized Blunt Point	516G100B	100 rings	10,000 rings	9 lbs.	100 boxes	900 lbs.
Galvan Sharp Point	516GF100	100 rings	10,000 rings	9 lbs.	100 boxes	900 lbs.
Stainless Steel Sharp Point	516SS100	100 rings	10,000 rings	9 lbs.	100 boxes	900 lbs.
Stainless Steel Blunt Point	516SS100B	100 rings	10,000 rings	9 lbs.	100 boxes	900 lbs.
Aluminum Sharp Point	516AL100	100 rings	10,000 rings	4 lbs.	100 boxes	400 lbs.
Aluminum Blunt Point	516AL100B	100 rings	10,000 rings	4 lbs.	100 boxes	400 lbs.

SR8

C Style

Primary Applications:

- B&B Trees
- Tagging Pots
- Bag Closure
- Cages
- Crafts
- Bird Control Netting
- Bungee Cords

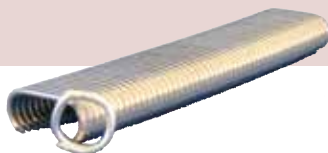
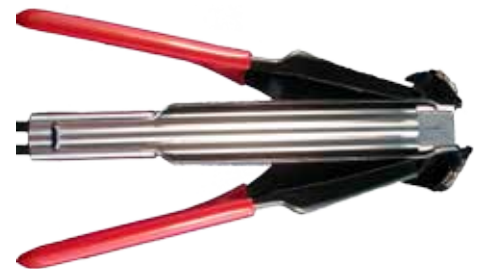

Description	Part #	Strip Size	Box Count	Box Weight	Box Per Skid	Skid Weight
Manual Tool	G7	-	-	1 lb.	-	-
Galvanized Sharp Point	SR8G	50 rings	2,500 rings	3 lbs.	750 boxes	2,250 lbs.
Galvanized Blunt Point	SR8GB	50 rings	2,500 rings	3 lbs.	750 boxes	2,250 lbs.
Stainless Steel Sharp Point	SR8SS	50 rings	2,500 rings	3 lbs.	750 boxes	2,250 lbs.

16110

C Style

Primary Applications:

- Animal Cages
- B&B Trees
- Insulation Blankets
- Bungee Cords
- Nursery Pot Tagging
- Silt Fence
- Traps
- Securing Wire Mesh
- Bag Closure
- Oil Absorption Socks

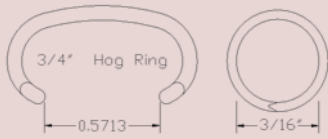

Description	Part #	Strip Size	Box Count	Box Weight	Box Per Skid	Skid Weight
Pneumatic Tool	HC716	-	-	3 lbs.	-	-
Galvanized Sharp Point	16G110	110 rings	11,000 rings	15 lbs.	100 boxes	1,500 lbs.
Galvanized Blunt Point	16G110B	110 rings	11,000 rings	15 lbs.	100 boxes	1,500 lbs.
Galvan (Bezinal) Sharp Point	16GF110	110 rings	11,000 rings	15 lbs.	100 boxes	1,500 lbs.
Stainless Steel Sharp Point	16SS110	110 rings	11,000 rings	15 lbs.	100 boxes	1,500 lbs.
Aluminum Sharp Point	16AL110	110 rings	11,000 rings	6 lbs.	100 boxes	600 lbs.

15100

C Style

Primary Applications:

- Furniture Industry
- Automotive Seating
- Animal Cages
- Bungee Cords
- Insulation
- Silt Fence
- Bag Closure
- Bedding

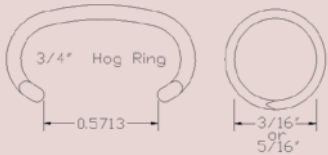

Description	Part #	Strip Size	Box Count	Box Weight	Box Per Skid	Skid Weight
Pneumatic Tool	HC715	-	-	3 lbs.	-	-
Pneumatic Tool (tight closure)	HC715T	-	-	3 lbs.	-	-
Bright Basic Sharp Point	15100	100 rings	10,000 rings	17 lbs.	100 boxes	1,700 lbs.
Bright Basic Blunt Point	15100B	100 rings	10,000 rings	17 lbs.	100 boxes	1,700 lbs.
Galvanized Sharp Point	15G100	100 rings	10,000 rings	17 lbs.	100 boxes	1,700 lbs.
Galvanized Blunt Point	15G100B	100 rings	10,000 rings	17 lbs.	100 boxes	1,700 lbs.
Stainless Steel Sharp Point	15SS100	100 rings	10,000 rings	17 lbs.	100 boxes	1,700 lbs.
Stainless Steel Blunt Point	15SS100B	100 rings	10,000 rings	17 lbs.	100 boxes	1,700 lbs.

1140

C Style

Primary Applications:

- Gabion Basket Installation
- Commercial Fence Installation
- Large Bag Closure
- Oil Absorption Socks
- Crafts
- Construction
- Erosion Control
- Swing Sets

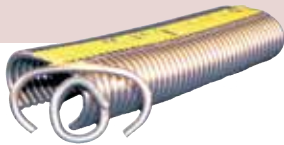

Description	Part #	Strip Size	Box Count	Box Weight	Box Per Skid	Skid Weight
Pneumatic Tool	HC1511	-	-	15 lbs.	-	-
Manual Tool	HC1511HT	-	-	7 lbs.	-	-
Low Tensile Galvanized Sharp Point	11RG40	40 rings	1,600 rings	16 lbs.	96 boxes	1,536 lbs.
Low Tensile Galvanized Blunt Point	11RG40B	40 rings	1,600 rings	16 lbs.	96 boxes	1,536 lbs.
High Tensile Galvanized Sharp Point	11G40	40 rings	1,600 rings	16 lbs.	96 boxes	1,536 lbs.
High Tensile Galfan Sharp Point	11GF40	40 rings	1,600 rings	16 lbs.	96 boxes	1,536 lbs.
Stainless Steel Sharp Point	11SS40	40 rings	1,600 rings	16 lbs.	96 boxes	1,536 lbs.
Aluminum Sharp Point	11AL40	40 rings	1,600 rings	6 lbs.	96 boxes	576 lbs.

515D50

D Style

Primary Applications:

- B&B Trees
- Tagging Pots
- Animal Cages
- Bag Closure
- Crafts
- Bird Control
- Lobster Pots

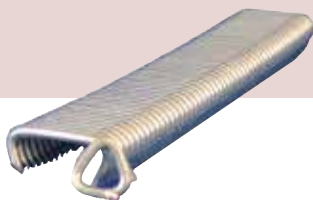

Description	Part #	Strip Size	Box Count	Box Weight	Box Per Skid	Skid Weight
Manual Tool	Ring-It	-	-	2 lbs.	-	-
Galvanized Sharp Point	515DG50	50 rings	2,500 rings	3 lbs.	750 boxes	2,250 lbs.
Galvanized Blunt Point	515DG50B	50 rings	2,500 rings	3 lbs.	750 boxes	2,250 lbs.
Stainless Steel Sharp Point	515DSS50	50 rings	2,500 rings	3 lbs.	750 boxes	2,250 lbs.
Stainless Steel Blunt Point	515DSS50B	50 rings	2,500 rings	3 lbs.	750 boxes	2,250 lbs.



KING-HUGHES FASTENERS

PRODUCT LINE

15D50

D Style

Primary Applications:

- Furniture Industry
- Seating
- Animal Cages
- Fence Industry
- Bungee Cords
- Bedding
- Bag Closure

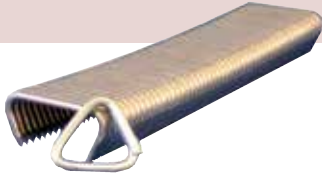

Description	Part #	Strip Size	Box Count	Box Weight	Box Per Skid	Skid Weight
Pneumatic (spring return & long mag.)	TR203	-	-	5 lbs.	-	-
Manual Tool	G22	-	-	1 lb.	-	-
Bright Basic Sharp Point	15D50	50 rings	10,000 rings	17 lbs.	100 boxes	1,700 lbs.
Galvanized Sharp Point	15DG50	50 rings	10,000 rings	17 lbs.	100 boxes	1,700 lbs.
Stainless Steel Sharp Point	15DSS50	50 rings	10,000 rings	17 lbs.	100 boxes	1,700 lbs.

HFP9

D Style

Primary Applications:

- Fence Industry
- Large Bag Closure
- Wire to Wire
- Arts and Crafts



Description	Part #	Strip Size	Box Count	Box Weight	Box Per Skid	Skid Weight
Manual Tool	KHFP9	-	-	1 lb.	-	-
Aluminum Sharp Point	09DAL25	25 rings	2,500 rings	10 lbs.	100 boxes	1,030 lbs.

Loose Rings



D Styles

Primary Applications:

- Furniture Industry
- Automotive Industry
- Landscape Industry
- Fence Industry

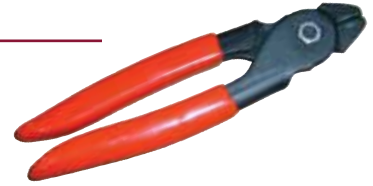
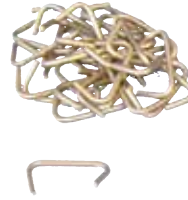

Description	Part #	Strip Size	Box Count	Box Weight	Box Per Skid	Skid Weight
15g Bright Loose Sharp (3/4")	15DL	-	-	25 lbs.	80	2,000 lbs.
15g Stainless Loose Blunt (3/8")	315DSSB	-	-	25 lbs.	80	2,000 lbs.
14g Galvanized Loose Blunt (3/8")	314DGB	-	-	25 lbs.	80	2,000 lbs.
14g Stainless Loose Blunt (3/8")	314DSSB	-	-	25 lbs.	80	2,000 lbs.
15g Stainless Loose Blunt (1/2")	515DSSB	-	-	25 lbs.	80	2,000 lbs.
14g Galvanized Loose Blunt (1/2")	514DGB	-	-	25 lbs.	80	2,000 lbs.
14g Stainless Loose Blunt (1/2")	514DSSB	-	-	25 lbs.	80	2,000 lbs.
15g Stainless Loose Blunt (3/4")	715DSSB	-	-	25 lbs.	80	2,000 lbs.
14g Galvanized Loose Blunt (3/4")	714DGB	-	-	25 lbs.	80	2,000 lbs.
14g Stainless Loose Blunt (3/4")	714DSSB	-	-	25 lbs.	80	2,000 lbs.

We are now stocking and supplying a variety of staples, clips and staplers to go along with the hog rings we manufacture. Below is a picture of just a small variety of staples and clips taken from our physical inventory. Please call us today to speak with one of our representatives who will gladly assist you with your stapling needs.





KING-HUGHES FASTENERS

PRODUCT LINE

Clip Type Fasteners

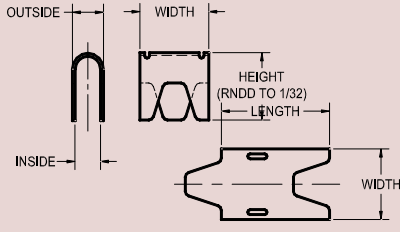

Description:

These high quality clips are used in a wide variety of applications when connecting multiple pieces of wire, cable, or rope together. They are available in a wide variety of material gauges and dimensions.

They are also available in a variety of materials. These clips are 100% produced in USA and are fully backed for quality and satisfaction. The clips are designed to work in all major manufacturers' clip tools available on the market.

Type EFC

Primary Applications:

- Mattress
- Furniture
- Animal Cages
- Concrete Pipe
- Lobster Pots
- Traps
- Bird Feeders
- Crafts
- Automotive Seating



KHF P/N	Hartco P/N	Tool P/N	Clips/Box
64A18SG	CLP-15G	2000-1020/1929	10,340
71A18SG	CLP-13G	2000-1020/1929	9,400
72E18S	CLP-20	2000-3236	6,110
74H18S	CLP-23	2000-6080	4,230
76A18R	CCP-26	2500-1020	14,500
80F23S	CLP-312	2000-6181	4,320
80H23S	CLP-3	2000-6181	3,600
80H23SG	CLP-3G	2000-6181	3,600
88A22R	CCP-32	2500-1022	12,300
88H23S	CLP-4	2000-6181	3,200
90F18SG	CLP-2412G	2000-6082	3,948
90H18S	CLP-24	2000-6082	3,290
90H18SC	CLP-24C	2000-6082	3,290
90H18SG	CLP-24G	2000-6082	3,290
101F23SAL	CL-34NAL	2000-4157T	3,360
101H23SG	CLP-34G	2000-6183	2,800
101H23S	CLP-34	2000-6183/6189	2,800
101H23SAL	CL-34AL	2000-6187T	2,800
101H23SC	CLP-34C	2000-6183	2,800
110E25SS4	CLP-35SS4	2000-6189E	2,886
110E25SS3	CLP-35SS3	2000-6189E	2,886
110H25S	CLP-36	2000-6189	2,220
110H25SAL	CL-36AL	2000-6187T	2,220
135H31S	CL-38T	2000-6788	1,550

CLIP TYPE:

S - Strip Type
R = Roll Form

MATERIAL TYPE:

G = Galvanized
AL = Aluminum
S = Stainless

SPECIAL FEATURE:

C = Cushion

Pneumatic Clip Tool

Type Eclipser

Description:

The Eclipser clip tool takes KHF ECF series clips available in materials from bright, galvanized, stainless and aluminum. The relatively low air consumption allows for use with standard compressors. The tool is designed for long service life and easy maintenance through careful engineering. Benefits of using this tool can be seen immediately in less man hours on the job, lower occurrences of installer injuries and lower per connection prices.

Extras Supplied:

Operators manual, spare parts list, service instructions. For safety reasons we recommend that your operators read and understand all safety precautions prior to operating the tool.

Primary Applications:

- Automotive Seating
- Bedding
- Commercial Fence Installation
- Concrete Pipe
- Crafts
- Erosion Control
- Construction
- Lobster Pots



Technical Data:	
Type Description:	Eclipser Long Magazine
Article Code:	Multiple
Magazine Type:	Rear Loading
Staple Type:	ECF Clips
Magazine Capacity:	31-47 depending on clip size
Fasteners per Strip:	31-47
Operating Pressure:	80-90 psi (5.5-6.2 Bar)
Max. Operating Pressure:	90 psi (6.2 Bar)
Air Consumption/Operation:	14 cu. inch (0.0002 cu. meter)
Inner Hose Diam. Required:	3/8" (10 mm) Ø recommended
Emission sound level at the workstation:	d = 82 dB
Weight:	4.40 lbs. (2 kg)

APPLICATION

RING SERIES	RING TYPE	INSULATION	CAGES	BUNGEE	BAG CLOSURE	NETTING	ROPE	OIL ABSORPTION	B&B	TAGGING	CRAFTS	SILT FENCE	TRAPS	WIRE MESH	SEATING	BEDDING	GABION BASKET	FENCING	CONSTRUCTION	LOBSTER POT	SWING SET	ARTS & CRAFTS
516	516G100B	•	•	•	•	•	•	•			•	•	•	•					•	•		
	516GF100	•	•	•	•	•	•	•			•	•	•	•					•	•		
	516SS100	•	•	•	•	•	•	•			•	•	•	•					•	•		
	516AL100B	•	•	•	•	•	•	•			•	•	•	•					•	•		
SR8	SR8G	•	•	•	•	•	•				•								•	•		
	SR8GB	•	•	•	•	•	•				•								•	•		
	SR8SS	•	•	•	•	•	•				•								•	•		
16110	16G110		•	•	•	•	•	•			•	•	•	•						•	•	
	16GF110		•	•	•	•	•	•			•	•	•	•						•	•	
	16SS110		•	•	•	•	•	•			•	•	•	•						•	•	
	16AL110		•	•	•	•	•	•			•	•	•	•						•	•	
15100	15100		•	•	•	•	•	•			•	•	•	•						•	•	
	15100B		•	•	•	•	•	•			•	•	•	•						•	•	
	15G100		•	•	•	•	•	•			•	•	•	•						•	•	
	15SS100		•	•	•	•	•	•			•	•	•	•						•	•	
1140	11RG40		•	•	•	•	•	•			•	•	•	•						•	•	
	11RG40B		•	•	•	•	•	•			•	•	•	•						•	•	
	11G40		•	•	•	•	•	•			•	•	•	•						•	•	
	11GF40		•	•	•	•	•	•			•	•	•	•						•	•	
515D50	515DG50		•	•	•	•	•	•			•	•	•	•						•	•	
	515DG50B		•	•	•	•	•	•			•	•	•	•						•	•	
	515DSS50		•	•	•	•	•	•			•	•	•	•						•	•	
	515DSS50B		•	•	•	•	•	•			•	•	•	•						•	•	
15D50	15D50		•	•	•	•	•	•			•	•	•	•						•	•	
	15DSS50		•	•	•	•	•	•			•	•	•	•						•	•	
	09DAL25		•	•	•	•	•	•			•	•	•	•						•	•	
LOOSE RINGS	15DL		•	•	•	•	•	•			•	•	•	•						•	•	
	314DGB		•	•	•	•	•	•			•	•	•	•						•	•	
	314DSSB		•	•	•	•	•	•			•	•	•	•						•	•	
	315DSSB		•	•	•	•	•	•			•	•	•	•						•	•	
	514DGB		•	•	•	•	•	•			•	•	•	•						•	•	
	514DSSB		•	•	•	•	•	•			•	•	•	•						•	•	
	515DSSB		•	•	•	•	•	•			•	•	•	•						•	•	
	714DGB		•	•	•	•	•	•			•	•	•	•						•	•	
	714DSSB		•	•	•	•	•	•			•	•	•	•						•	•	
	715DSSB		•	•	•	•	•	•			•	•	•	•						•	•	